

PULSTAR®

SureCall®
RAISE YOUR BARS

2023 Product Catalog



ABOUT SURECALL

SureCall leads the market for performance and reliability. Since 2001, SureCall has been the first-to-market pioneer of innovative cell phone signal boosters that improves cell service inside vehicles, homes and commercial spaces across North America.

Our premium components and innovative engineering has developed consumer and enterprise signal boosters that maintain the highest standards for performance and reliability.

We are dedicated to going above and beyond for our customers. This fuels our commitment to quality and industry-leading customer satisfaction suite - which includes lifetime 24/7 US-based support.

Whether you need better cell service in a big space, little space, car, truck or RV, in the extremes or somewhere in between, SureCall has a solution to boost your cell service.



**ALL-CARRIER
BOOSTERS**



**PERFORMANCE
LEADER**



**LONG-TERM
RELIABILITY**



**3-YEAR
WARRANTY**



**24/7 US-BASED
SUPPORT**



**INNOVATIVE
TECHNOLOGY**



"No signal for 2 years and now I have LTE and can tether my laptop."
– Turts, Customer from Amazon



"Great customer support, great system and does what is supposed to..."
– Fordguy2013, Customer from Amazon

CONTENTS



VEHICLE / RV / FLEET

4

Experience more miles of uninterrupted coverage while on the road. SureCall's line of vehicle signal boosters are designed to capture the outside signal and rebroadcast it to you and your passengers.



RESIDENTIAL

10

SureCall's residential booster kits improve cell service and reduce dropped calls inside small offices and homes.



COMMERCIAL

20

Designed for medium and large buildings, SureCall's commercial boosters provide people and businesses with enhanced connectivity.



ACCESSORIES

30

Use SureCall accessories to aid installation, customize, expand or accommodate your SureCall booster.

1:

VEHICLE, RV & FLEET SIGNAL BOOSTERS

Powerful solutions for fleets and frequenters of the cellular network's fringe, grab-n-go solutions for easy install, and support for those who call the road home – SureCall has solutions for all drivers and passengers, fleets, and RV'ers.

Vehicle Products

Product Name	Additional Details	Compatibility	Coverage Type	Page
N-Range 2.0	Single device booster stays connected at a greater range	5G/4G LTE data, voice & text	Single device	5
Fusion2Go 3.0	Max power & fastest data for multiple devices	5G/4G LTE data, voice & text	Vehicle interior	6
Fusion2Go MAX	Max power & fastest data at maximum range to tower	5G/4G LTE data, voice & text	Remote vehicles	7
Fusion2Go 3.0 RV	Max power & fastest data for multiple devices in RV	5G/4G LTE data, voice & text	RV interior	8
Fusion2Go OTR	Max power & fastest data for multiple devices made for OTR vehicles	5G/4G LTE data, voice & text	Cabin interior	9



"When I'm chasing storms I would often drop calls and lose data. I had used signal boosters from other companies but they can't deliver nearly the boost the SureCall Fusion2Go 3.0 gives me."

– Steve Polley, Storm Chaser at MesoExtreme Media



Hands-
Free Cradle



N-Range 2.0

The most reliable cellular connection for a single-device in your vehicle

Model: SC-NRange2

With only two main components, SureCall's revolutionary N-Range 2.0 cell phone signal booster for vehicles installs in as little as 90 seconds and increases your voice and data speed for a single device inside any car, truck or SUV.

5G compatible - Fusion2Go Max supports 4G and 5G devices, including MiFi hotspots and cellular datahubs.

The N-Range 2.0 uses Extended Range Technology™ (ERT) to capture and amplify signal at its strongest point, *outside the vehicle*, to deliver maximum signal quality and speed directly to your device. It also boosts the return signal, offering the maximum in vehicle-to-tower reach.

Installation is quick and the entire N-Range kit can be easily transferred between vehicles, making it simple for drivers to receive the most reliable cell reception wherever they go.

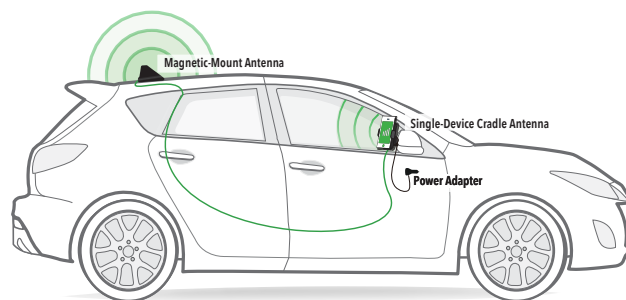

Compatibility	5G/4G LTE data, voice & text
Coverage	Single device
Max Gain	23 dB
RF Connectors	SMA-Female
Uplink Frequencies (MHz)	698-716 / 776-787 / 824-849 / 1850-1915 / 1710-1755
Downlink Frequencies (MHz)	728-746 / 746-757 / 869-894 / 1930-1995 / 2110-2155

N-RANGE 2.0 KIT

MSRP: \$ 199⁹⁹



Any Car, Truck
or SUV



5G/4G LTE Data,
Voice & Text



Single Device



Extended Range
Technology

VEHICLE / RV / FLEET

Top
Seller



Fusion2Go 3.0

Most powerful voice, text & data signal booster for vehicles

Model: SC-Fusion2Go3

Boosting cellular signals with 2X more power and faster data speeds than the closest competitor, Fusion2Go 3.0 is the go-to solution for fleets, drivers, and passengers who need access to reliable voice, text, and data signals in the toughest to reach areas.

5G compatible - Fusion2Go 3.0 supports 4G and 5G devices, including MiFi hotspots and cellular datahubs.

Fusion2Go 3.0 uses a bi-directional amplifier system with a low-profile 3" exterior antenna that can hold up to the harshest of conditions to capture, enhance and broadcast a stronger and more reliable cell signal inside your vehicle. Simply plug-in the power supply, position the magnetic antenna on the roof and Fusion2Go 3.0 will keep you connected further from the tower than any other vehicle booster on the market.

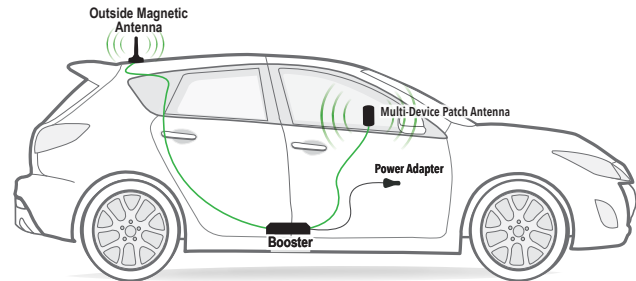

Compatibility	5G/4G LTE data, voice & text
Coverage	Vehicle Interior (multiple devices)
Max Gain	50 dB
RF Connectors	FME Male
Uplink Frequencies (MHz)	698-716 / 776-787 / 824-849 / 1850-1915 / 1710-1755
Downlink Frequencies (MHz)	728-746 / 746-757 / 869-894 / 1930-1995 / 2110-2155

FUSION2GO 3.0

MSRP: \$ 399⁹⁹



Any Car, Truck
or SUV



5G/4G LTE Data,
Voice & Text



Multiple
Devices



Max
Performance

Award-Winning



Fusion2Go Max

CES 2020 Innovation Award – North America's #1 performing vehicle signal booster maximizes cell service on the road

Model: SC-Fusion2GoMax

Stop dropped calls and improve text and cellular data inside of any car, truck, van, or SUV. Fusion2Go Max boosts cell service for all cellular devices and every cell carrier in the US, Canada, and Mexico for the best performance in urban and rural environments.

5G compatible - Fusion2Go Max supports 4G and 5G devices, including MiFi hotspots and cellular datahubs.

Fusion2Go Max uses Extended Range Technology™ (ERT) to capture cell signals at their strongest point outside the vehicle, improving signal quality and speed. It also boosts the return signal more than any other device in the market, offering the maximum in vehicle-to-tower reach. This vastly improves cell signal connectivity while also conserving the battery life of your devices.

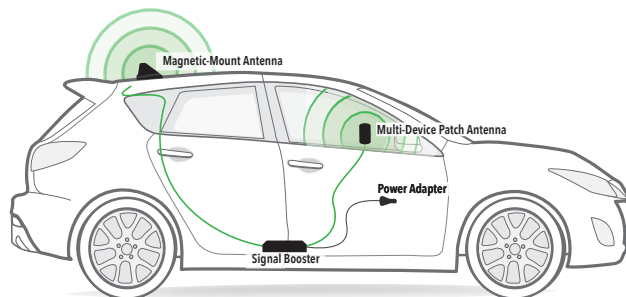

Compatibility	5G/4G LTE data, voice & text
Coverage	Entire vehicle (multiple devices)
Max Gain	50 dB
RF Connectors	FME Male
Uplink Frequencies (MHz)	698-716 / 776-787 / 824-849 / 1850-1915 / 1710-1755
Downlink Frequencies (MHz)	728-746 / 746-757 / 869-894 / 1930-1995 / 2110-2155

FUSION2GO MAX

MSRP: \$ 499⁹⁹



Any Car, Truck or SUV



5G/4G LTE Data, Voice & Text



Multiple Devices



Extended Range Technology

VEHICLE / RV / FLEET

Award-
Winning



BEST OF 2023

Fusion2Go 3.0 RV

PC Mag Best of 2023: Most powerful RV booster with 2x more power than the closest competitor

Model: SC-Fusion2Go3-RV

Boosts 5G / 4G LTE data, voice & text signals for all major carriers inside any RV or Motorhome

Reduces dropped and missed calls for multiple devices

Improves data speeds for multiple devices for more miles of uninterrupted coverage

Built in safeguards completely eliminate interference to cell tower

Fastest upload and download data speeds in weak signal areas

5G compatible - Fusion2Go 3.0 RV supports 4G and 5G devices, including MiFi hotspots and cellular datahubs

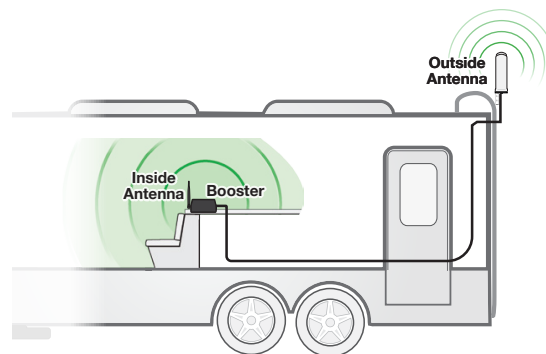

Compatibility	5G/4G LTE data, voice & text
---------------	------------------------------

Coverage	Entire RV (Multiple devices)
----------	------------------------------

Max Gain	50 dB
----------	-------

RF Connectors	FME Male
---------------	----------

Uplink Frequencies (MHz)	698-716 / 776-787 / 824-849 / 1850-1915 / 1710-1755
--------------------------	-----------------------------------------------------

Downlink Frequencies (MHz)	728-746 / 746-757 / 869-894 / 1930-1995 / 2110-2155
----------------------------	-----------------------------------------------------

FUSION2GO 3.0 RV

MSRP: \$ 449⁹⁹



Use in Any RV or
Motorhome



5G/4G LTE Data,
Voice & Text



Multiple
Devices



Max
Performance

NEW



Fusion2Go OTR

Most Powerful Over-the-Road Truck Cell Signal Booster
Designed for Large Vehicles

Model: SC-Fusion2Go3-OTR

The high-performance Fusion2Go OTR vehicle cell phone signal booster improves 5G/4G LTE cellular signal strength for all North American carriers. Maximum interior coverage and connectivity for multiple simultaneous users on all phones, devices, and cellular hotspots.

The durable, weather-tested OTR antenna permanently mounts to any large vehicle and withstands the most rugged road conditions. It is optimized for heavy-duty trucks, work vans, fleets, trailers, off-road vehicles, and RVs.

16" and 32" antenna height options are available with the optional mast extension. Includes 10 ft cable length (integrated) with 5 ft extension (optional) with 2-clamp mounting bracket. The kit also includes cable adapters for the most common vehicle signal boosters with SMB-Female and SMA-Male ends for universal connectivity. The OTR antenna fits 3/8 x 24 thread mount for added versatility.

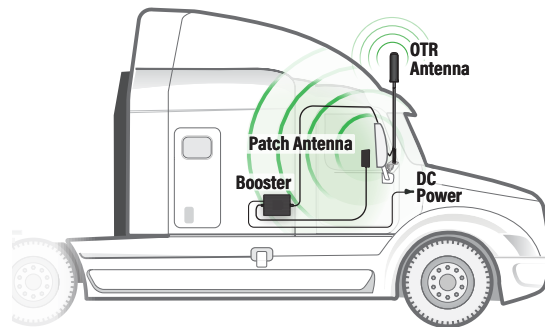

Compatibility	5G/4G LTE data, voice & text
Coverage	Cabin Interior (multiple devices)
Max Gain	50 dB
RF Connectors	FME Male
Uplink Frequencies (MHz)	698-716 / 776-787 / 824-849 / 1850-1915 / 1710-1755
Downlink Frequencies (MHz)	728-746 / 746-757 / 869-894 / 1930-1995 / 2110-2155a

FUSION2GO OTR

MSRP: \$ 529⁹⁹



Truck, Fleet
or Semi



5G/4G LTE Data,
Voice & Text



Multiple
Devices



Permanent
Installation

VEHICLE / RV / FLEET



SureCall's residential booster kits improve cell service and reduce dropped calls inside small offices and homes of any size.

Residential Products

Product Name	Additional Details	Compatibility	Coverage	Page
Fusion4Home	Powerful booster for medium-size homes	5G/4G LTE data, voice & text	Up to 5,000 sq ft	12
Fusion4Home Max	Powerful booster for medium-size homes	5G/4G LTE data, voice & text	Up to 6,500 sq ft	14
Flare 3.0	Best booster for medium homes in rural areas	5G/4G LTE data, voice & text	Up to 3,500 sq ft	15
Fusion Professional	Powerful booster for medium buildings or large homes	5G/4G LTE data, voice & text	Up to 8,000 sq ft	16
Fusion Install	Residential signal booster PLUS professional home installation	5G/4G LTE data, voice & text	Up to 8,000 sq ft	17
Fusion5s 2.0	Powerful booster for mid to large-size homes	5G/4G LTE data, voice & text	Up to 10,000 sq ft	18



"I live in an old house that started out life with wood siding. Over the years it has taken on many exteriors including stucco and most recently metal siding and roof over all of it. Needless to say cell signal doesn't penetrate much. This booster gives me full bars in most of the house. It is amazing not to have to do the where can I get signal dance. Thanks so much!"

– Shannon, FlareDB+ Customer





CUSTOMER STORIES

REBUILDING & RECONNECTING AFTER HURRICANE MARIA

Hurricane Maria was at its full category 5 force when it landed at St. Croix and collided head-on with Ridge to Reef Farm. In addition to decimating the 130 acre farm all nearby cell towers had been torn down, which required multiple daily trips up a nearby mountain to make a call or send a text.

Nate Olive, owner of Ridge to Reef Farm, was cautiously hopeful when installing the SureCall Fusion4Home after similar solutions were unable to help. Much to his excitement, the Fusion4Home reconnected them with five full bars inside the main home. "We went from No Service to back in business after 30 minutes of installation," explained Nate Olive.



FULL BARS FOR VERIZON 4G LTE IN A TEXAS HOME

Brenda and Jack Whitehead had no cell service, landline, or Internet inside their 1,600 sq. ft. all-metal country home in Dike, Texas. After 7-years of calling, texting, and using data outside in the teeth-chatting cold or intense heat, the couple turned to the SureCall Fusion4Home.

With Fusion4Home, Brenda and Jack have full bars for Verizon and T-Mobile throughout their home! Jack now operates his business without the stress of missing communication and Brenda can call, text and use 4G LTE data right from the comfort of home.

"My husband didn't think it would work but we are totally amazed, I mean we get FULL bars for Verizon when we have always had No Service." - Brenda Whitehead

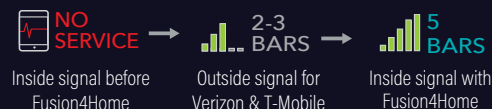



Fusion4Home

Improves voice, text & data signals inside medium-size homes

Model: SC-PolyH-72-YP-Kit



Boosts 5G / 4G LTE data, voice & text signals for all North American cell carriers



Improves coverage up to 5,000 sq ft inside buildings and large residences



2XP™ technology delivers twice the signal power when compared to the closest competitor to stay connected with distant cell towers



SureIQ™ balances incoming signals, ensuring 24/7 uptime and continuous peak performance in both urban and rural areas



5G compatible - Fusion4Home supports 4G and 5G devices, including MiFi hotspots and cellular datahubs

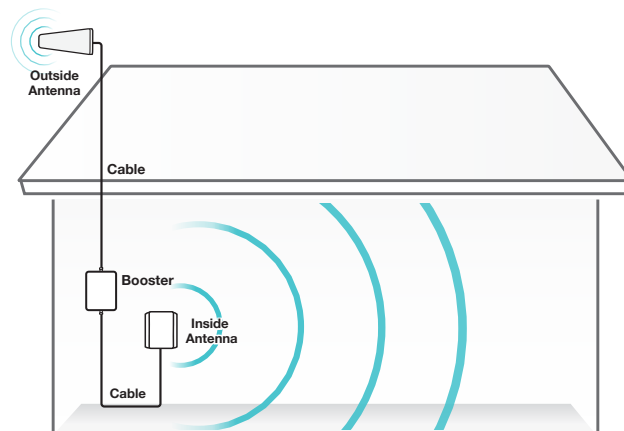

Shown: Fusion4Home Yagi / Panel kit

Compatibility	5G/4G LTE data, voice & text
Coverage	Up to 5000 ^{sq ft}
Max Gain	72 dB
RF Connectors	F-Female (Outside) / N-Female (Inside)
Uplink Frequencies (MHz)	698-716 / 776-787 / 824-849 / 1850-1915 / 1710-1755
Downlink Frequencies (MHz)	728-746 / 746-757 / 869-894 / 1930-1995 / 2110-2155

KITS STARTING AT MSRP: \$ 299⁹⁹



Outside antenna options



Omni-directional



Yagi, Directional

Inside antenna options



Whip,
Omni-directional



Panel,
Directional

ESTIMATED COVERAGE	OUTSIDE SIGNAL	1-2 BARS OUTSIDE	3-4 BARS OUTSIDE	5 BARS OUTSIDE
	FUSION4HOME			
	OMNI/WHIP KIT	500 sq ft	1000 sq ft	2000 sq ft
	YAGI/WHIP KIT	1000 sq ft	2000 sq ft	3000 sq ft
	YAGI/ PANEL KIT	2000 sq ft	3000 sq ft	5000 sq ft

Fusion4Home Kit Options



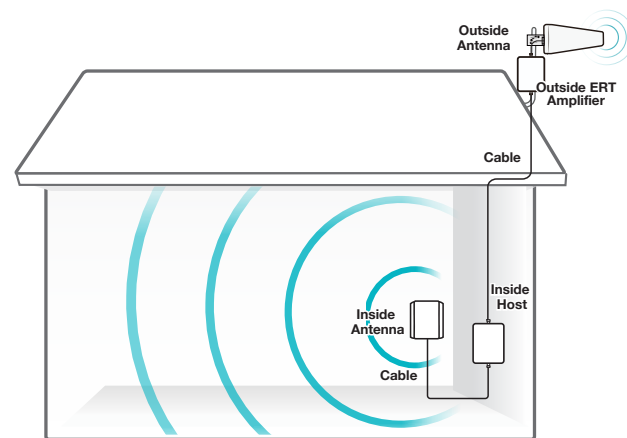

Model name	Model number	Outside antenna	Inside antenna(s)	MSRP
Fusion4Home Omni / Whip Kit	SC-PolyH-72-ORA-Kit	(1) Omni	(1) Whip	\$299.99
Fusion4Home Yagi / Whip Kit	SC-PolyH-72-YRA-Kit	(1) Yagi	(1) Whip	\$399.99
Fusion4Home Yagi / Panel Kit	SC-PolyH-72-YP-Kit	(1) Yagi	(1) Panel	\$499.99



Fusion4Home Max

Most Powerful Cell Signal Booster for Suburban and Rural Homes with Extended Range Technology

Model: SC-Fusion4HomeMax

-  Boosts 5G and 4G LTE data, voice & text signal for all North American cell carriers
-  Improves coverage up to 6,500 sq ft inside buildings and large residences
-  2XP™ technology delivers twice the signal power when compared to the closest competitor to stay connected with distant cell towers
-  Maximum indoor coverage and signal quality improvement with Extended Range Technology
-  5G compatible - Fusion4Home Max supports 4G and 5G devices, including MiFi hotspots and cellular datahubs

ESTIMATED COVERAGE

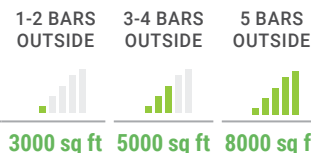

Compatibility	5G/4G LTE data, voice & text
Coverage	Up to 6500 sq ft
Max Gain	72 dB
RF Connectors	N-female (inside) / F-female (outside)
Uplink Frequencies (MHz)	698-716 / 776-787 / 824-849 / 1850-1915 / 1710-1755
Downlink Frequencies (MHz)	728-746 / 746-757 / 869-894 / 1930-1995 / 2110-2155

FUSION4HOME MAX KIT

MSRP: \$ 549⁹⁹

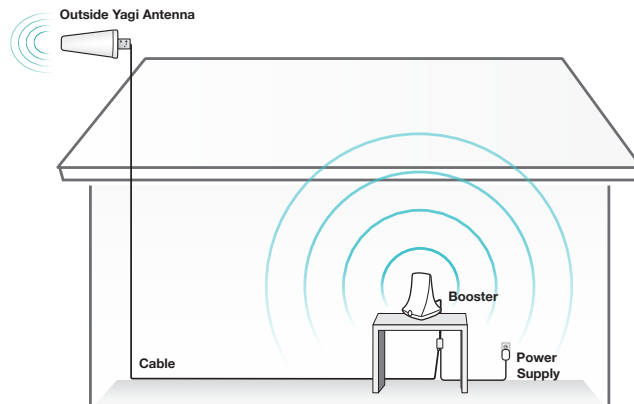

Flare 3.0

PC Mag Editors' Choice for Best Home Cell Phone Signal Booster

Model: SC-Flare3US



Boosts 5G / 4G LTE data, voice & text signals for all North American cell carriers



Covers 2-4 rooms in a home or office, up to 3,500 sq ft



2XP technology delivers twice the signal power to the tower when compared to the closest competitor to keep all devices connected in suburban and remote/rural areas



5G compatible - Flare 3.0 supports 4G and 5G devices, including MiFi hotspots and cellular datahubs



The strongest outdoor directional Yagi antenna ensures connectivity even in challenging signal locations



Simplified installation with combined amplifier and indoor antenna in one base unit designed for an open tabletop or shelf

ESTIMATED COVERAGE



Compatibility	5G/4G LTE data, voice & text
Coverage	Up to 3500 sq ft
Max Gain	72 dB
RF Connectors	F-Female
Uplink Frequencies (MHz)	698-716 / 776-787 / 824-849 / 1850-1915 / 1710-1755
Downlink Frequencies (MHz)	728-746 / 746-757 / 869-894 / 1930-1995 / 2110-2155

FLARE 3.0 KIT

MSRP: \$ 379⁹⁹

RESIDENTIAL

15



Best
Performance



Fusion Professional

Most powerful cell signal booster for mid-size buildings up to 8,000 sq ft

Model: SC-FusionPro



Boosts 5G / 4G LTE data, voice & text signals for all North American cell carriers



Improves coverage up to 8,000 sq ft inside buildings and large residences



2XP™ technology delivers twice the signal power when compared to the closest competitor to stay connected with distant cell towers



SureIQ™ balances incoming signals, ensuring 24/7 uptime and continuous peak performance in both urban and rural areas



5G compatible - Fusion Professional supports 4G and 5G devices, including MiFi hotspots and cellular datahubs

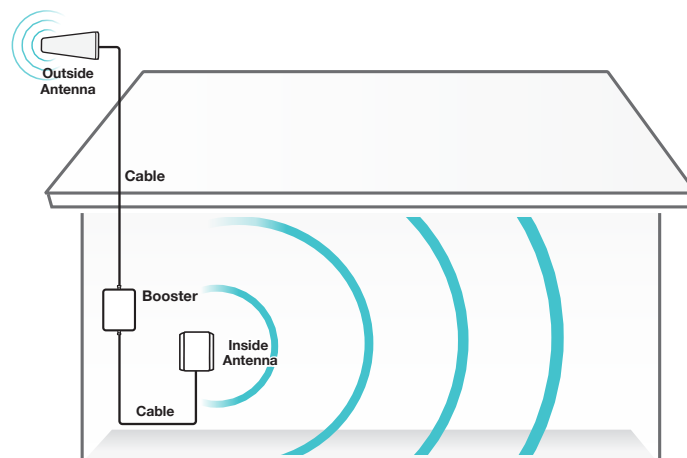

ESTIMATED COVERAGE

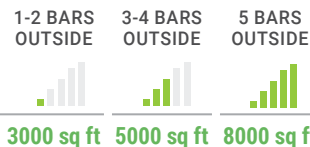

Compatibility	5G/4G LTE data, voice & text
Coverage	Up to 8000 sq ft
Max Gain	72 dB
RF Connectors	N-Female (Outside) / N-Female (Inside)
Uplink Frequencies (MHz)	698-716 / 776-787 / 824-849 / 1850-1915 / 1710-1755
Downlink Frequencies (MHz)	728-746 / 746-757 / 869-894 / 1930-1995 / 2110-2155

FUSION PROFESSIONAL KIT MSRP: \$ 599⁹⁹



Fusion Install

Most powerful cell signal booster plus professional home installation

Model: SC-FusionInstall



Boosts 5G / 4G LTE data, voice & text signals for all North American cell carriers



Improves cell coverage inside any residence



Includes professional installation for residences through our trusted install partner OnTech Smart Services



2XP™ technology delivers twice the signal power when compared to the closest competitor to stay connected with distant cell towers



SureIQ™ balances incoming signals, ensuring 24/7 uptime and continuous peak performance in both urban and rural areas



5G compatible - Fusion Install supports 4G and 5G devices, including MiFi hotspots and cellular datahubs

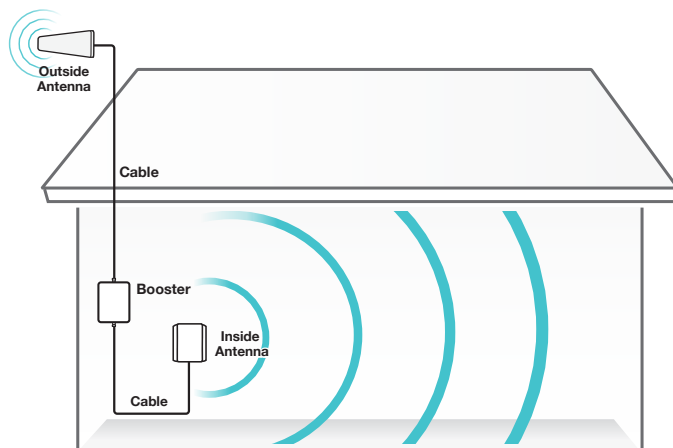

ESTIMATED
COVERAGE

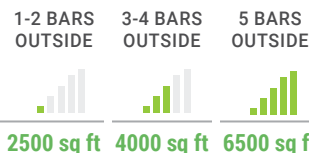

Compatibility	5G/4G LTE data, voice & text
Coverage	Up to 6500 sq ft
Max Gain	72 dB
RF Connectors	F-Female (Outside) / N-Female (Inside)
Uplink Frequencies (MHz)	698-716 / 776-787 / 824-849 / 1850-1915 / 1710-1755
Downlink Frequencies (MHz)	728-746 / 746-757 / 869-894 / 1930-1995 / 2110-2155

FUSION INSTALL KIT

MSRP: \$ 899⁹⁹

RESIDENTIAL

17





Fusion5s 2.0

Improves cell phone service inside large homes

Model: SC-PolysH/O-72-OD-Kit

The SureCall Fusion5s 2.0 cell phone signal booster increases cellular signal strength for improved 5G / 4G LTE data, voice and text connectivity up to 10,000 sq. ft. for all North American cell carriers.

5G compatible - Fusion5s 2.0 supports 4G and 5G devices, including MiFi hotspots and cellular datahubs.

Multiple kitting options provide the flexibility to customize installation for any building or floor plan.

Compatible with Sentry remote monitoring.



Large Home /
Small Office



5G/4G LTE Data,
Voice & Text



Up to 10,000 ^{sq ft}
Coverage



Max
Performance

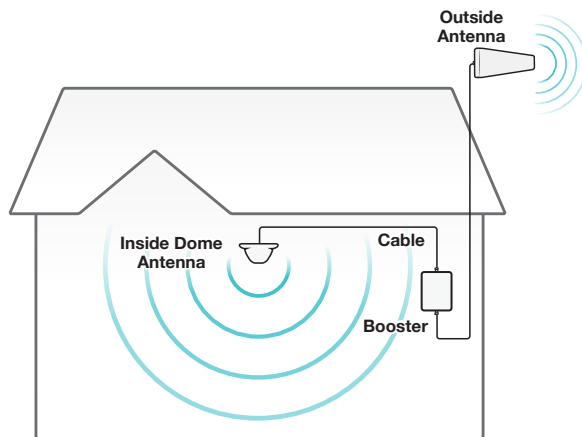

Shown: Fusion5S 2.0 Standard Yagi / Dome Kit

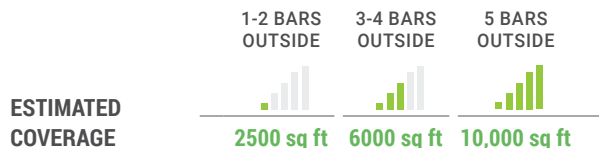

* Additional antennas may be needed to reach maximum coverage.

Compatibility	5G/4G LTE Data, Voice & Text
Coverage	Up to 10,000 ^{sq ft}
Max Gain	72 dB
RF Connectors	N-Female (Outside) / N-Female (Inside)
Uplink Frequencies (MHz)	698-716 / 776-787 / 824-849 / 1850-1915 / 1710-1755
Downlink Frequencies (MHz)	728-746 / 746-757 / 869-894 / 1930-1995 / 2110-2155

STARTING AT

MSRP: \$ 849⁹⁹



Outside antenna options



Inside antenna options



Fusion5s 2.0 Kit Options

Model name	Model number	Outside antenna	Inside antenna(s)	MSRP
Fusion5s 2.0 Omni/Dome Kit	SC-PolysH/O-72-OD-Kit	(1) Omni	(1) Dome	\$849.99
Fusion5s 2.0 Omni/Panel Kit	SC-PolysH/O-72-OP-Kit	(1) Omni	(1) Panel	\$849.99
Fusion5s 2.0 Yagi/Dome Kit	SC-PolysH/O-72-YD-Kit	(1) Yagi	(1) Dome	\$849.99
Fusion5s 2.0 Yagi/Panel Kit	SC-PolysH/O-72-YP-Kit	(1) Yagi	(1) Panel	\$849.99
Fusion5s 2.0 Yagi/2 Dome Kit	SC-PolysH/O-72-YD2-Kit	(1) Yagi	(2) Domes	\$1,099.00
Fusion5s 2.0 Yagi/2 Panel Kit	SC-PolysH/O-72-YP2-Kit	(1) Yagi	(2) Panels	\$1,099.00



3

COMMERCIAL SIGNAL BOOSTERS

SureCall's commercial boosters provide businesses and the people within them with enhanced connectivity in mid-size, large and enterprise buildings. Customizable kitting options accommodate a variety of needs and our free iBwave certified system design service is available for buildings over 10,000 square feet.

Commercial Products

Product Name	Additional Details	Compatibility	Coverage	Page
5X Max	Scalable ERT & Cloud management	5G/4G LTE voice & data signals	Large & enterprise buildings	22
Fusion5X 2.0	Top performing and 24/7 uptime	5G/4G LTE voice & data signals	Mid-size buildings	24
Force5 2.0	Built-in sentry monitoring system	5G/4G LTE voice & data signals	Large & enterprise buildings	26
Force8	Industry's first 5G Booster	Voice, text, data & 5G for T-Mobile (600 MHz) band	Large & enterprise buildings	28

"SureCall boosters are the most durable and reliable we've used. Our client's trust us with solutions and we trust SureCall to produce reliable and high-performance signal amplifiers and antennas."
 – Sina Khanifar of RepeaterStore



"Quite simply, it's [SureCall Force5] a bullet-proof performer."
 – Joe Comizio of DAS Worldwide



iBwave Certified Project Design Service

Free for installations exceeding 10,000 square feet and requiring multiple indoor antennas, SureCall's Design Configuration Assistance Program connects you with our iBwave certified network designers to ensure you and your customer get top-tier performance from your configuration.

SureCall's Design Configuration Assistance Program saves you time and money. Our iBwave certified network design experts provide a project layout and itemized bill of materials — all customized for your specific floorplan. Prediction mapping allows you to see exactly how the coverage will flow throughout the building, so you know what the configuration will deliver even before it has been installed.

This service is provided free for installations exceeding 10,000 square feet that require multiple indoor antennas.

Get started by completing the Design Service Questionnaire at SureCall.com or to learn more, email one of our network designers at design@surecall.com

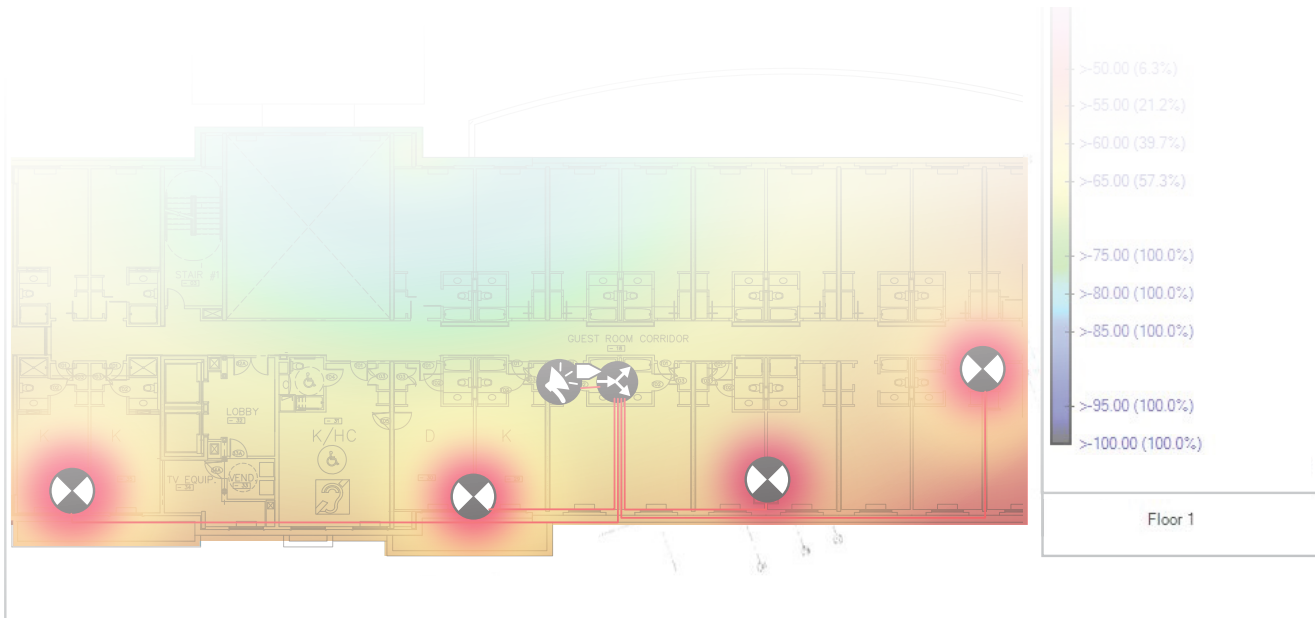

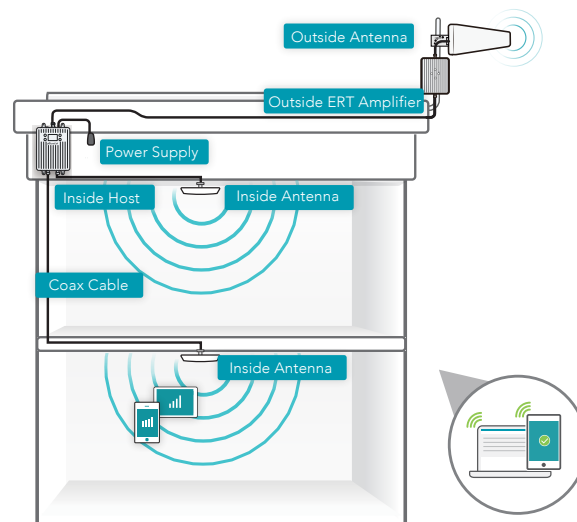

Shown: 5X Max / 2-Ultra Thin Dome kit

5X Max

Industry-leading commercial cell phone signal booster with Extended Range Technology

Model: SC-5XMax-Y2U

Instantly improve cellular signal indoors for all carriers and devices with the most powerful commercial cell phone signal booster equipped with EXTENDED RANGE TECHNOLOGY™ (ERT) designed for large offices, residential MDUs, industrial and enterprise buildings along with educational and business campuses.

The 5X Max is the first commercial booster to feature SureCall's proprietary ERT which overcomes signal loss in the outdoor cable by amplifying cell signals at the strongest point outside the building.

This revolutionary innovation provides maximum performance and connectivity for a larger indoor coverage area, max tower range and fastest data speeds when compared to the closest competitor.

Also features two fully-powered inside antenna ports which can accommodate up to 12 antennas with additional components

Compatibility	5G / 4G LTE voice & data signals
Coverage	Large & enterprise buildings
Max Gain	72 dB
RF Connectors	N-Female (Outside) and N-Female (Inside)
Uplink Frequencies (MHz)	698-716 / 776-787 / 824-849 / 1850-1915 / 1710-1755
Downlink Frequencies (MHz)	728-746 / 746-757 / 869-894 / 1930-1995 / 2110-2155

STARTING AT

MSRP: \$ 5,999



Large & Enterprise



5G/4G LTE Data, Voice & Text



Built-in Cloud Monitoring



ERT Technology



Outside antenna



Yagi, Directional

Inside antenna options



Panel, Directional



Ultra Thin™
Omni-directional

5X Max Kit Options

Model name	Model number	Outside antenna	Inside antenna(s)	MSRP
5X Max Yagi / 2 Ultra-thin	SC-5XMax-Y2U	(1) Yagi	(2) Ultra-thins	\$5,999.99
5X Max Yagi / 2 Panel	SC-5XMax-Y2P	(1) Yagi	(2) Panels	\$5,999.99

Top
Seller



Fusion5X 2.0

Best-in-class performance and complete offsite cloud monitoring and control

Model: SC-Fusion5X2-OD

All-Carrier Signal Booster for 5G / 4G LTE voice, text & data signals

Compatible with SureCall Cloud™ for offsite monitoring anytime, anywhere

Max Coverage: +16 dBm downlink power for 2X more coverage than the closest competitor

Customizable Kit Options to fit any medium office or large home

Built-In SureIQ™ for 24/7 uptime at peak performance

5G compatible - Fusion5x 2.0 supports 4G and 5G devices, including MiFi hotspots and cellular datahubs

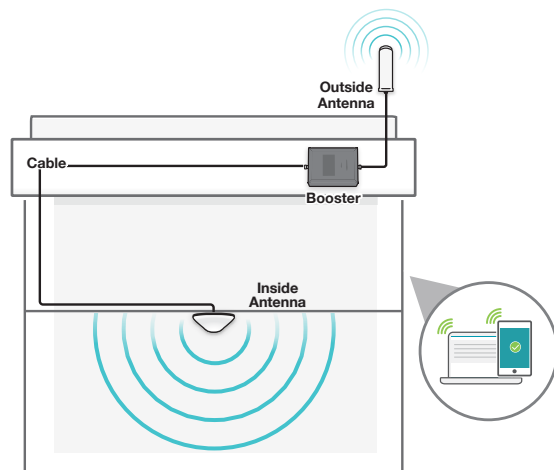

Shown: Fusion5X 2.0 Omni / Ultra Thin kit

Compatibility	5G / 4G LTE voice & data signals
Max Coverage	Mid-size buildings
Max Gain	72 dB
RF Connectors	N-Female (Outside) and N-Female (Inside)
Uplink Frequencies (MHz)	698-716 / 776-787 / 824-849 / 1850-1915 / 1710-1755
Downlink Frequencies (MHz)	728-746 / 746-757 / 869-894 / 1930-1995 / 2110-2155

STARTING AT

MSRP: \$ 1,649



Mid-Size
Building



5G/4G LTE Voice
& Data Signals



Double
the Power



SureIQ
Technology



Outside antenna options



Omni-directional



Yagi, Directional

Inside antenna options



Dome,
Omni-directional



Panel, Directional



Ultra Thin™
Omni-directional

Fusion5X 2.0 Kit Options

Model name	Model number	Outside antenna	Inside antenna(s)	MSRP
Fusion5X 2.0 Omni / Dome Kit	SC-Fusion5X2-OD	(1) Omni	(1) Dome	\$1,649.00
Fusion5X 2.0 Omni / 4 Dome Kit	SC-Fusion5X2-O4D	(1) Omni	(4) Dome	\$1,999.00
Fusion5X 2.0 Omni / Panel Kit	SC-Fusion5X2-OP	(1) Omni	(1) Panel	\$1,649.00
Fusion5X 2.0 Omni / 4 Panel Kit	SC-Fusion5X2-O4P	(1) Omni	(4) Panels	\$1,999.00
Fusion5X 2.0 Yagi / Dome Kit	SC-Fusion5X2-YD	(1) Yagi	(1) Dome	\$1,649.00
Fusion5X 2.0 Yagi / 4 Dome Kit	SC-Fusion5X2-Y4D	(1) Yagi	(4) Domes	\$1,999.00
Fusion5X 2.0 Yagi / Panel Kit	SC-Fusion5X2-YP	(1) Yagi	(1) Panel	\$1,649.00
Fusion5X 2.0 Yagi / 4 Panel Kit	SC-Fusion5X2-Y4P	(1) Yagi	(4) Panels	\$1,999.00
Fusion5X 2.0 Omni / Ultra Thin Kit	SC-Fusion5X2-OU	(1) Omni	(1) Ultra Thin	\$1,749.00
Fusion5X 2.0 Yagi / Ultra Thin Kit	SC-Fusion5X2-YU	(1) Yagi	(1) Ultra Thin	\$1,749.00
Fusion5X 2.0 Omni / 4 Ultra-Thin Kit	SC-Fusion5X2-O4U	(1) Omni	(4) Ultra Thin	\$2,249.00
Fusion5X 2.0 Yagi / 4 Ultra-Thin Kit	SC-Fusion5X2-Y4U	(1) Yagi	(4) Ultra Thin	\$2,249.00

Award
Winning



Force5 2.0

Industry-leading commercial grade cell phone signal booster for large buildings

Model: SC-PolyO2-72-OD4-Kit

The award-winning Force5 2.0 is the next evolution in cellular signal boosting technology and the #1 DAS alternative. Force5 2.0, equipped with max downlink power, provides improved 5G/4G LTE voice, text and data signals for the largest coverage in urban commercial buildings.

5G compatible - Force5 2.0 supports 4G and 5G devices, including MiFi hotspots and cellular datahubs.

Built-in SureIQ™ technology balances incoming signals, preventing shutdown and maximizing performance in strong signal environments.

Additionally, the Force5 2.0 is the first ever cell phone signal booster equipped with SureCall's built-in Sentry remote monitoring system, allowing integrators to optimize booster performance during installation and while off-site via mobile app or desktop interface.

Extended 5-Year warranty available

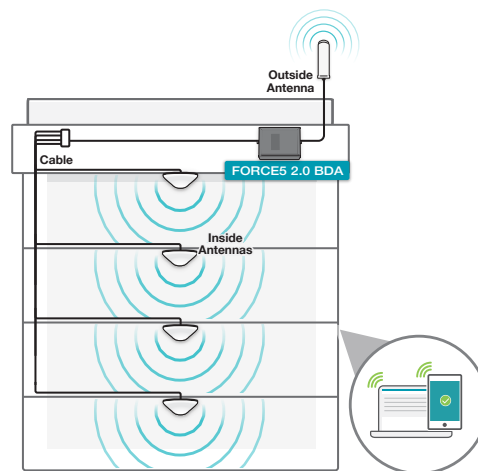

Shown: Force5 2.0 Omni / 4-Ultra Thin Dome kit

Compatibility	5G / 4G LTE voice & data signals
Coverage	Large & enterprise buildings
Max Gain	72 dB
RF Connectors	N-Female (Outside) and N-Female (Inside)
Uplink Frequencies (MHz)	698-716 / 776-787 / 824-849 / 1850-1915 / 1710-1755
Downlink Frequencies (MHz)	728-746 / 746-757 / 869-894 / 1930-1995 / 2110-2155

STARTING AT

MSRP: \$ 4,195



Large & Enterprise



5G/4G LTE Data, Voice & Text



Built-in Sentry Monitoring



SureIQ Technology



Outside antenna options



Omni-directional



Yagi, Directional

Inside antenna options



Dome,
Omni-directional



Panel, Directional



Ultra Thin™
Omni-directional

Force5 2.0 Kit Options

Model name	Model number	Outside antenna	Inside antenna(s)	MSRP
Force5 2.0 Omni / Dome	SC-PolyO2-72-OD	(1) Omni	(1) Dome	\$4,195.00
Force5 2.0 Omni / 4 Dome	SC-PolyO2-72-OD4	(1) Omni	(4) Domes	\$4,595.00
Force5 2.0 Omni / Panel	SC-PolyO2-72-OP	(1) Omni	(1) Panel	\$4,195.00
Force5 2.0 Omni / 4 Panel	SC-PolyO2-72-OP4	(1) Omni	(4) Panel	\$4,595.00
Force5 2.0 Yagi / Dome	SC-PolyO2-72-YD	(1) Yagi	(1) Dome	\$4,195.00
Force5 2.0 Yagi / 4 Dome	SC-PolyO2-72-YD4	(1) Yagi	(4) Domes	\$4,595.00
Force5 2.0 Yagi / Panel	SC-PolyO2-72-YP	(1) Yagi	(1) Panel	\$4,195.00
Force5 2.0 Omni / 4 Ultra Thin	SC-PolyO2-72-O4U	(1) Omni	(4) Ultra Thin	\$4,595.00
Force5 2.0 Yagi / 4 Ultra Thin	SC-PolyO2-72-Y4U	(1) Yagi	(4) Ultra Thin	\$4,595.00

First
5G Booster

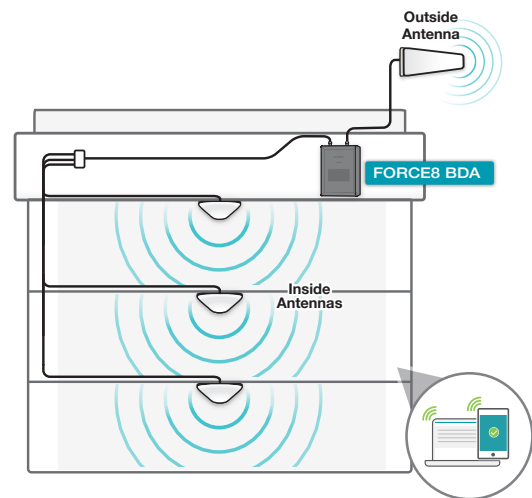

Force8 BDA and Optional Antennas

Force8 Industrial

Sentry™ equipped 5G and 4G LTE signal amplifier for large buildings

Model: SC-Force8

First 5G signal booster that improves 5G service inside buildings for T-Mobile (600 MHz)

Improves voice, text and data signals for every US cell carrier

Eliminates dropped and missed calls in buildings up to 80,000-square-feet*

Built-in remote monitoring hardware allows cloud controlled adjustments to the booster anytime and anywhere via mobile SureCall Cloud app (iPhone | Android)

Each band is independently configurable to function in the most challenging environments

Customizable kitting and multi-amplifier scalability provide the flexibility to accommodate any floor plan

Compatibility	T-Mobile 5G (600 MHz), 5G/4G LTE voice, text and data signals
Coverage	Large & enterprise buildings
Max Gain	80 dB
RF Connectors	N-Female (Outside) and N-Female (Inside)
Uplink Frequencies (MHz)	663-716 / 776-787 / 819-849 / 1850-1915 / 1710-1755
Downlink Frequencies (MHz)	617-652 / 728-746 / 746-757 / 864-894 / 1930-1995 / 2110-2155

STARTING AT

MSRP: \$ 8,399



Large & Enterprise



5G/4G LTE Data, Voice & Text



Built-in Sentry Monitoring



5G Booster for T-Mobile



Case Study

SCOTSMAN ICE SYSTEMS

THE CHALLENGE

A 60,000 sq ft. corporate office and a 30,000 sq ft. warehouse space was suffering from an unusably weak cellular signal inside the building's walls.

The survey indicated that the building was equidistant from two AT&T cell towers, which created a congested outside cellular signal that unpredictably transferred calls from one cell tower to the other.

THE SOLUTION

RSRF identified that Scotsman would need a turn-key solution that could support all carriers and also affordable, deployable within a short time-frame, reliable and low- or no-maintenance.

In five days, the team had installed two donor antennas outside of the building; one yagi antenna pointed at an AT&T tower and an omni-directional antenna to capture Verizon and all other carriers. Within the building they had also installed 7 SureCall Force5 cellular amplifiers, 48 indoor panel and dome antennas, and plenum coaxial cabling.



No Service Inside

Indoor signal was weak or non-existent



1-2 Bars Outside

Outside signal for low for Verizon and sporadic for AT&T



4-5 Bars with SureCall

Reliable signal throughout the building!

THE RESULTS

Teams at Scotsman's HQ office now receive 4-5 bars on every major cellular network in every room of their new office and have run the solution without error since installation.



5:

ACCESSORIES

Use SureCall accessories to aid installation, customize, expand or accommodate your SureCall booster

Accessory type	Page
Installation Tools	31
Antennas	33
Cables	36
Connectors and adapters	38



INSTALLATION TOOLS

Signal Meter

SureCall Signal Meter

Model: SC-METER-01



Useful installation tool to efficiently ensure an a successful Installation by measuring RF signal levels for LTE, AWS, PCS and Cellular Frequencies.

Use the whip antenna to quickly assess indoor signal levels and map coverage needs then, measure outdoor signal levels to determine the ideal location for outdoor antenna placement.

Also, identify peak antenna alignment by connecting the meter directly to the antenna using a provided cable.

MSRP: \$ 399

Sentry™

Remote Monitoring System

Model: SC-Sentry



SureCall's Sentry is a revolutionary advancement in signal-booster management, aiding in the installation, optimization, and ongoing management of compatible SureCall boosters. Installers are provided tools to optimize booster during installation, as well as, manage while located off-site using the iPhone® or Android® app, or through desktop interface. Sentry also sends email alerts to notify users of important status changes. For use with Fusion5s 2.0 and Fusion5X 2.0.

MSRP: \$ 480

J-Pole Mount

Outdoor Antenna Mounting Pole

Model: SC-MOUNT-JBAR



Adjustable 20" J-bar outdoor antenna mounting pole. SureCall's universal mounting pipe allows you to position the exterior antenna higher for optimal reception. The bracket attaches to any flat surface including a roof, fascia, side of house, or deck rail. Aluminum. Diameter: 1 inch.

MSRP: \$ 40

Cellular Modem

SureCall Cellular Modem

Model: SC-Modem



SureCall's Cellular Modem with built-in Router enables easy off-site booster adjustments without a wired Internet connection. SC-Modem offers wireless access to the remote management hardware — allowing for operation independent of the building's wired Ethernet or Wi-Fi connection.

MSRP: \$ 399



INSTALLATION TOOLS



Cable Prep Tool

SC-400 Coaxial Cable Prep tool

Model: SC-400-Prep

All-in-one combination prep and stripping tool for SC-400 coaxial cable. Use this handy tool to quickly trim coax cable to proper conductor length and braid exposure length.

MSRP: \$ 179⁹⁹



Cable Prep Tool

SC-600 Coaxial Cable Prep tool

Model: SC-600-Prep

Use this handy tool to quickly trim SC-600 cable to proper conductor length and braid exposure length. Designed to easily prepare coax cable for assembly of both crimp and clamp connectors.

MSRP: \$ 179⁹⁹



Cable Crimper

SC-400 Coaxial Cable Crimper

Model: SC-Crimp

Commercial-grade cable crimper with multiple cavity sizes secures connectors to SC-400 coaxial cable. Attach the N-Male crimp connector (SC-CN-09) to SC-400 cable with this handy tool.

MSRP: \$ 74



Cable Crimper

SC-600 Coaxial Cable Crimper

Model: SC-600-Crimp

Commercial-grade cable crimper secures crimp connectors to SC-600 coaxial cable. Attach the N-Male crimp connector (SC-CN-16) to SC-600 cable with this handy tool.

MSRP: \$ 239⁹⁹

VEHICLE ANTENNAS

Wide Band Directional Interior Patch Antenna

SC-110W



Frequency	698 - 2700 MHz
Impedance	50 ohm
Gain	1 dBi / 3 dBi Gain
Connectors	FME-Female (10 ft cable)
MSRP	\$10.40

Wide Band Interior Omni-Directional Whip Antenna

SC-120W



Frequency	698 - 2700 MHz
Impedance	50 ohm
Gain	3 dBi
Connectors	FME-Female
MSRP	\$10.40

Ultra-Wideband Omni-Directional OTR Exterior Truck Antenna

SC-550W



Frequency	617 - 2700 MHz
Impedance	50 ohm
Gain	3-5 dBi
Connectors	FME-Female (Cable: 10 ft integrated, 5 ft optional)
MSRP	\$ 129.99

Wide Band Magnetic Roof-Mount Antenna

SC-200W-58



Frequency	698 - 2700 MHz
Impedance	50 ohm
Gain	5 dBi
Connector	FME-Female (10 ft cable)
MSRP	\$ 20

Wide Band Magnet-Mount Roof Antenna

SC-208W



Frequency	698 - 2700 MHz
Impedance	50 ohm
Gain	1 to 2 dBi
Connector	FME-Female (10 ft cable)
MSRP	\$ 38.99

Wide Band NMO (Non Magnetic Option) Exterior Roof Antenna

SC-203WN



Frequency	698 - 2700 MHz
Impedance	50 ohm
Gain	3.5 to 7.5 dBi
Connector	FME-Female (17 ft cable)
MSRP	\$49



ANTENNAS - OUTSIDE

Outside antennas are generally mounted outdoors. They should be placed in the area of best signal in order to receive the strongest possible signal from the cell tower. Omni-directional outside antennas send and receive signal from all directions; Directional antennas are aimed in the direction of best signal.

Omni-directional Wideband

SC-289W



Frequency	698 - 2700 MHz
Impedance	50 Ω / 75 Ω
Gain	3 to 4 dBi
Connectors	N-Female / F-Female
MSRP	\$ 78

Directional Yagi Wideband

SC-231W



Frequency	698 - 2700 MHz
Impedance	50 Ω / 75 Ω
Gain	10 to 11 dBi
Connectors	N-Female / F-Female
MSRP	\$ 90

Signal Catcher™ Directional Indoor Window-Mount Wideband

SC-510W



Frequency	698 - 2700 MHz
Impedance	50 Ω
Gain	7 to 10 dBi
Connectors	N-Female
MSRP	\$ 179.99

Omni-directional Ultra-Wideband

SC-588W



Frequency	617 - 2700 MHz
Impedance	50 Ω
Gain	1.5 / 2 / 4 dBi
Connectors	N-Female
MSRP	\$ 99.99

Directional Yagi Ultra-Wideband

SC-530W



Frequency	617 - 2700 MHz
Impedance	50 Ω
Gain	7 / 8 / 9 dBi
Connectors	N-Female
MSRP	\$ 116.99

ANTENNAS - INSIDE

Inside antennas communicate with devices indoors receiving and sending boosted signal back to the cell tower. Omni-directional Indoor antennas provide 360-degree hemispherical coverage suitable for mostly square areas while directional antennas provide a focused zone of coverage suitable for long narrow areas.

Omni-Directional Whip Wideband

SC-121W



Omni-Directional Dome Wideband

SC-222W



Directional Panel Wideband

SC-248W



Frequency	698 - 2700 MHz	698 - 2700 MHz	698 - 2700 MHz
Impedance	50 Ω	50 Ω	50 Ω
Gain	3 dBi	3 to 4 dBi	7 to 10 dBi
Connector	N-Male	N-Female	N-Female
MSRP	\$ 10.40	\$ 38	\$ 58

Omni-Directional Dome Ultra Thin™ Ultra-Wideband

SC-528W



Directional Panel Ultra-Wideband

SC-548W



Frequency	617 - 2700 MHz	617 - 2700 MHz
Impedance	50 Ω	50 Ω
Gain	2 / 4 / 6 dBi	5.5 / 6 / 8 dBi
Connector	N-Female	N-Female
MSRP	\$ 109.99	\$ 74.99



COAXIAL CABLE

SC-240 Ultra Low-Loss 50 Ohm Cable



Model number	Description	Connectors	MSRP
SC-004-10-FF	10 ft, SC-240 Ultra Low-Loss, White	FME-Female/FME-Male	\$ 19
SC-004-10-FN	10 ft, SC-240 Ultra Low-Loss, White	FME-Female/N-Male	\$ 19
SC-004-20-FF	20 ft, SC-240 Ultra Low-Loss, White	FME-Female/FME-Male	\$ 27
SC-004-20-FN	20 ft, SC-240 Ultra Low-Loss, White	FME-Female/N-Male	\$ 27
SC-004-40-FN	40 ft, SC-240 Ultra Low-Loss, White	FME-Female/N-Male	\$ 45

SC-240 Insertion Loss Length (Ft / M)	Frequency (MHz)* dB, at 68°F		
	698-960	1710-2170	2200-2690
10 / 3.05	<0.99 dB	<1.5 dB	<1.69 dB
20 / 6.10	<1.78 dB	<2.7 dB	<2.98 dB
40 / 12.20	<3.35 dB	<5.1 dB	<5.7 dB

SC-400 Ultra Low-Loss 50 Ohm Cable



Model number	Description	Connectors	MSRP
SC-001-02	2 ft, SC-400 Ultra Low-Loss Coax Cable - Black	N-Male	\$ 15.20
SC-001-10	10 ft, SC-400 Ultra Low-Loss Coax Cable - Black	N-Male	\$ 25
SC-001-20	20 ft, SC-400 Ultra Low-Loss Coax Cable - Black	N-Male	\$ 35
SC-001-30	30 ft, SC-400 Ultra Low-Loss Coax Cable - Black	N-Male	\$ 50
SC-001-50	50 ft, SC-400 Ultra Low-Loss Coax Cable - Black	N-Male	\$ 66
SC-001-75	75 ft, SC-400 Ultra Low-Loss Coax Cable - Black	N-Male	\$ 98
SC-001-100	100 ft, SC-400 Ultra Low-Loss Coax Cable - Black	N-Male	\$ 112
SC-001-500	500 ft, SC-400 Ultra Low-Loss Coax Cable - Black	None	\$ 420
SC-002-500	500 ft, SC-400 Ultra Low-Loss Coax Cable - White	None	\$ 420
SC-001-1000	1,000 ft, SC-400 Ultra Low-Loss Coax Cable - Black	None	\$ 840
SC-002-1000	1,000 ft, SC-400 Ultra Low-Loss Coax Cable - White	None	\$ 840

SC-400 Insertion Loss Length (Ft / M)	Frequency (MHz)* dB, at 68°F		
	698-960	1710-2170	2200-2690
2 / 0.61	<0.29 dB	<0.43 dB	<0.49 dB
10 / 3.05	<0.63 dB	<0.94 dB	<1.08 dB
20 / 6.10	<1.06 dB	<1.58 dB	<1.81 dB
30 / 9.15	<1.49 dB	<2.23 dB	<2.54 dB
50 / 15.24	<2.34 dB	<3.50 dB	<4.00 dB
75 / 22.86	<3.40 dB	<5.10 dB	<5.83 dB
100 / 30.48	<4.47 dB	<6.70 dB	<7.66 dB

SC-600 Ultra Low-Loss 50 Ohm Cable

Model number	Description	Connectors	MSRP
SC-006-500	500 ft, SC-600 Ultra Low-Loss Cable - Black	None	\$ 1,150
SC-006-1000	1,000 ft, SC-600 Ultra Low-Loss Coax Cable - Black	None	\$ 2,300

COAXIAL CABLE (CONT'D)

RG-6 75 Ohm Cable



Model number	Description	Connectors	MSRP
SC-RG6-50	50 ft, RG-6 Cable, White	F-Male	\$ 19
SC-RG6-75	75 ft, RG-6 Cable, White	F-Male	\$ 26.50

RG-11 Low-Loss 75 Ohm Cable



Model number	Description	Connectors	MSRP
SC-RG11-50	50 ft, RG-11 Low-loss Cable, Black	F-Male	\$ 30
SC-RG11-100	100 ft, RG-11 Low-loss Cable, Black	F-Male	\$ 49

SC-400 Plenum 50 Ohm Cable





Model number	Description	Connectors	MSRP
SC-PL-30	30 ft, Ultra Low-Loss Coax Plenum Fire-Rated, Orange	N-Male	\$ 288
SC-PL-75	75 ft, Ultra Low-Loss Coax Plenum Fire-Rated, Orange	N-Male	\$ 645
SC-PL-500	500 ft, Ultra Low-Loss Coax Plenum Fire-Rated, Orange	None	\$ 1,875
SC-PL-1000	1000 ft, Ultra Low-Loss Coax Plenum Fire-Rated, Orange	None	\$ 3,750







UL-rated for plenum ceilings (UL E473791)

Please refer to data sheet for further details and technical specs





CONNECTORS AND ADAPTERS

Diplexers	Model #		MSRP
	SC-DPLX-01	Wide-band frequency-selective distribution device	\$58
Splitters			
	SC-WS-2-5G	2-Way Ultra-Wideband	\$58
	SC-WS-3-5G	3-Way Ultra-Wideband	\$74
	SC-WS-4	4-Way Wide Band	\$78
	SC-WS-4-5G	4-Way Ultra-Wideband	\$99
Couplers			
	SC-C-6-5G	-6 dB Ultra-Wideband	\$72
	SC-C-10	-10 dB Wideband	\$56
	SC-C-10-5G	-10 dB Ultra-Wideband	\$72
	SC-C-15-5G	-15 dB Ultra-Wideband	\$72

Attenuators	Model #		MSRP
	SC-ATNR-5	5 dB RF Attenuator	\$40
	SC-ATNR-10	10 dB RF Attenuator	\$40
	SC-ATNR-20	20 dB RF Attenuator	\$40
Connectors			
	SC-CN-01	N Female to N Female Connector	\$6.98
	SC-CN-02	N Male to SMA Female Connector	\$6.98
	SC-CN-03	N Male to FME Female Connector	\$6.98
	SC-CN-04	N Male to FME Male Connector	\$8.98
	SC-CN-05	N Male to SMA Male Connector	\$6.98
	SC-CN-06	SMA Male to FME Male Connector	\$5



Connectors (cont'd)	Model #		MSRP
	SC-CN-07	N Female to SMA Male Cable Connector	\$9.98
	SC-CN-08	SMA Male to FME Female Connector	\$6.98
	SC-CN-09	N Male Crimp Connector, SC400 and Plenum Cable	\$6.98
	SC-CN-10	N Female to FME Female Connector	\$6.98
	SC-CN-11	N Female to FME Male Connector	\$6.98
	SC-CN-12	N Male to N Male Connector	\$6.98
	SC-CN-13	FME Female to SC240 cable crimp	\$10
	SC-CN-14	FME Male to SC240 cable crimp	\$10
	SC-CN-15	N Male to SC240 cable crimp	\$10
	SC-CN-16	N Male Connector, SC600 Cable	\$10
	SC-CN-17	FME Female to SMA Female Connector	\$9
	SC-CN-18	N Male to F Male Connector	\$10
	SC-CN-19	F Female to F Female Connector	\$10
	SC-CN-20	N Male to F Female Connector	\$9
	SC-CN-22	F Male to N Female Connector	\$9

Lightning Protectors	Model #		MSRP
	SC-LP	Lightning Protector for 50Ω SC-400 or SC-600	\$58
	SC-LP-75	Lightning Protector for 75Ω RG6 or RG11 cable	\$58



/ CONTACT

info@surecall.com

(888) 365-6283

48346 Milmont Drive
Fremont, CA 94538

Stay connected with the performance leader

surecall.com

